

ROOT PRUNING NOTES

- ROOTS SHALL BE CLEANLY CUT USING MECHANICAL ROOT PRUNER, VIBRATORY KNIFE OR SIMILAR EQUIPMENT THAT WILL RESULT IN CLEAN CUTS.
- IF ROOT PRUNING TRENCH IS CUT USING EXCAVATION EQUIPMENT W/O UT ROOT PRUNER/VIBRATORY FLOW/ETC, ALL ROOTS ONE INCH OR GREATER MUST BE CUT BY HAND USING PRUNERS.
- TRENCH SHOULD BE IMMEDIATELY BACKFILLED WITH EXCAVATED SOIL OR OTHER ORGANIC SOIL.
- ROOT PRUNE TRENCH MUST BE MINIMUM DEPTH OF 24 INCHES.
- LOCATION OF ROOT PRUNE TRENCH COINCIDES WITH LOCATION OF TREE PROTECTION FENCE, EXTENTS AS SHOWN ON PLAN VIEW.

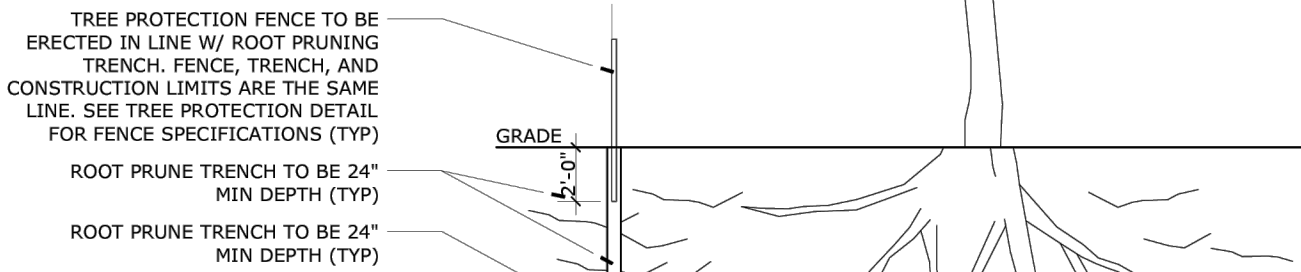

B ROOT PRUNING DETAIL
SCALE: NTS

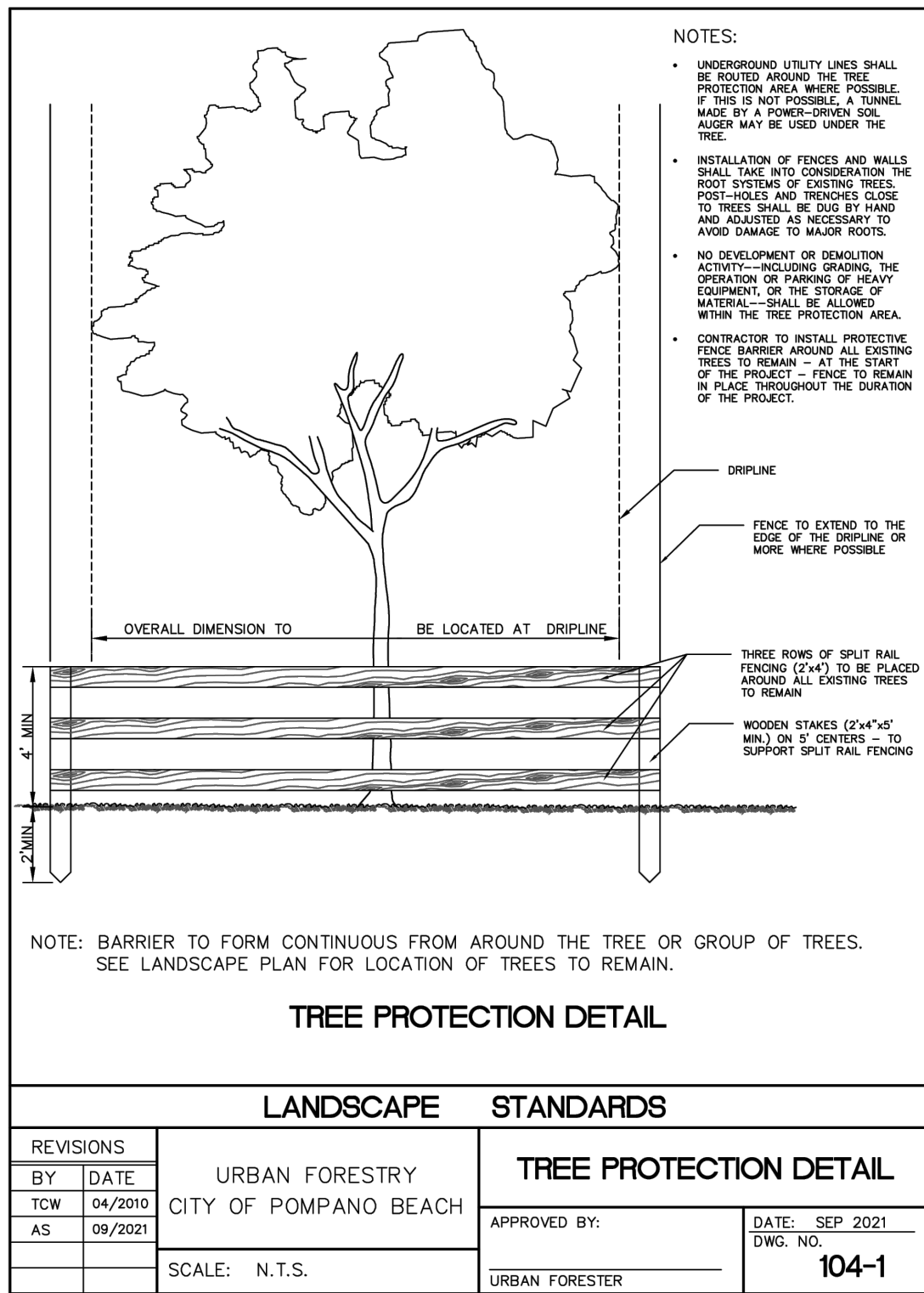

TREE PROTECTION NOTE

All existing trees and shrubs to remain in place shall be protected from damage by machinery by installing temporary tree protection fence and installed as indicated on plan. Suitable tree protection methods shall be approved by the City.

TREE RELOCATION AND PROTECTION NOTES

- All trees to be relocated to be tagged in field with orange tree tape
- Tree relocation areas to be selectively cleared and set at final design grade prior to general site clearing and grubbing and according to city code requirements
- If possible all relocations to be done by 80" tree spade. If relocation by tree spade is not feasible, then hand digging will be required
- Tree relocation to be coordinated with general contractor on site to determine scheduling
- Identify all underground utilities prior to tree relocation
- Temporary automatic watering system to be in place prior to commencement
- Relocated trees to be set at final design grade
- All relocated trees to be watered on a daily basis so as to maintain a permanently moist root ball until tree is established
- All existing trees and shrubs to remain in place shall be protected from damage by machinery by installing temporary tree protection fence and installed as indicated on plan. Suitable tree protection methods shall be approved by the City.
- Trees over four inches in caliper that are to be relocated will be root pruned at least eight weeks in advance of their moving date

FINES AND PENALTY NOTE:

Any encroachment within the tree protection zone, failure to maintain the tree protection zone, or any damage to the tree(s) or critical root zones will result in mitigation. The cause of damages would include, but not be limited to, storage of materials, placing fill or debris, disposal of paint or solvents, parking of machines under trees or tree protection zone encroachment. An example of this would be; Violations of this will result in a fine of \$1000.00 for the first offense, \$1500.00 for the second, and \$2000.00 for the third, etc. If physical damage is done to the tree, an appraisal of the damages and related fees will be determined by an ASCA Registered Consulting Arborist, and be based on all, or a percentage of, the established value assigned to the tree.

PRECONSTRUCTION NOTE:

A Pre-Construction meeting with Urban Forestry is required before any work is performed onsite, where there is tree protection and/or plant material is installed on site.

DEBRIS REMOVAL NOTE:

All road rock, concrete, asphalt and other non natural material be removed from all planting areas prior to landscape installation and be replaced with planting soil prior to landscape installation.

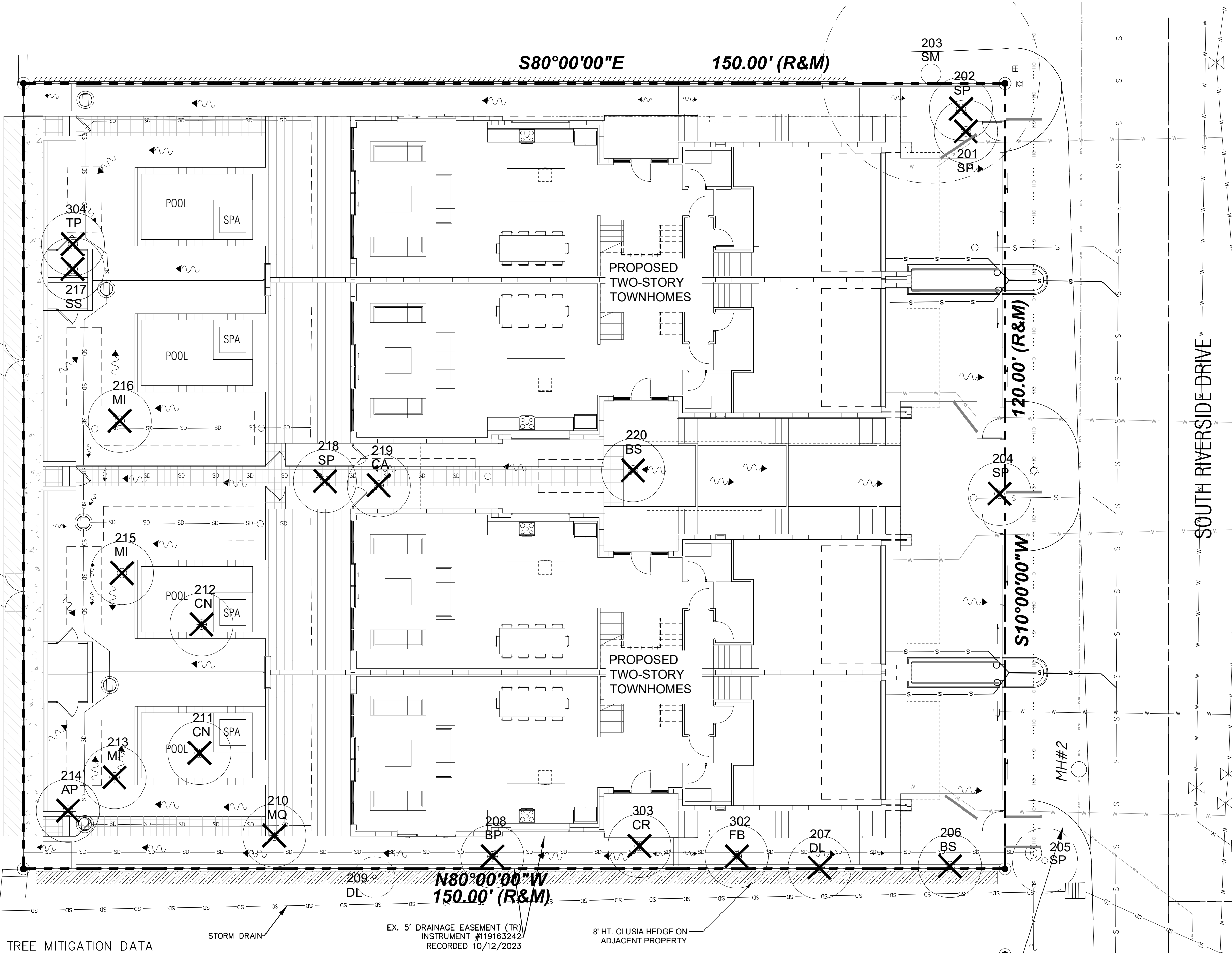

TREE MITIGATION DATA

TREE REPLACEMENT: ADD 1 CALIPER INCH PER 1 DBH INCH REMOVED IN ADDITION TO REQUIRED TREES
TOTAL DBH INCHES REMOVED: 160 INCHES
TOTAL CALIPER INCHES PROPOSED: 0 INCHES
MITIGATION REPLACEMENT WILL BE PAID TO THE CITY OF POMPAÑO BEACH TREE FUND

PALM REPLACEMENT: 1 FOR 1
TOTAL PALMS REMOVED: 7 PALMS
TOTAL PALMS PROPOSED: 7 PALMS

TREE DISPOSITION CHART

TREE NO.	SCIENTIFIC NAME	COMMON NAME	DBH (IN)	HEIGHT (FT)	SPREAD (FT)	CONDITION	DISPOSITION	MITIGATION
201	<i>Sabal palmetto</i>	Sabal Palm	15	12	15	80%	REMOVE	1 PALM
202	<i>Sabal palmetto</i>	Sabal Palm	10	4	10	80%	REMOVE	1 PALM
203	<i>Swietenia mahagoni</i>	Mahogany	35	55	45	55%	REMAIN	
204	<i>Sabal palmetto</i>	Sabal Palm	10	12	12	75%	REMOVE	1 PALM
205	<i>Sabal palmetto</i>	Sabal Palm	10	10	12	75%	REMAIN	
206	<i>Bursera simaruba</i>	Gumbo Limbo	15	30	35	50%	REMOVE	15"
207	<i>Dyopsis lutescens</i>	Areca Palm	4	15	15	50%	REMOVE	1 PALM
208	<i>Schinus terebinthifolia</i>	Brazilian Pepper	45	30	30	invasive	REMOVE	invasive
209	<i>Dyopsis lutescens</i>	Areca Palm	4	15	15	50%	REMAIN	
210	<i>Melaleuca quinquenervia</i>	Melaleuca	70	30	40	invasive	REMOVE	invasive
211	<i>Cocos nucifera</i>	Coconut Palm	13	25	15	75%	REMOVE	1 PALM
212	<i>Cocos nucifera</i>	Coconut Palm	13	25	15	75%	REMOVE	1 PALM
213	<i>Mangifera indica</i>	Mango	45	35	30	55%	REMOVE	45"
214	<i>Casuarina equisetifolia</i>	Austrailian Pine	10	15	8	invasive	REMOVE	invasive
215	<i>Mangifera indica</i>	Mango	35	30	25	50%	REMOVE	35"
216	<i>Mangifera indica</i>	Mango	20	25	15	40%	REMOVE	20"
217	<i>Sideroxylon salicifolium</i>	Willow Bustic	30	35	30	45%	REMOVE	30"
218	<i>Sabal palmetto</i>	Sabal Palm	13	15	15	80%	REMOVE	1 PALM
219	<i>Cupaniopsis anacardiodes</i>	Carrotwood	10	15	10	invasive	REMOVE	invasive
220	<i>Bursera simaruba</i>	Gumbo Limbo	15	15	15	55%	REMOVE	15"
302	<i>Ficus benjamina</i>	Weeping Fig	6	25	8	overgrown hedge	REMOVE	overgrown hedge
303	<i>Clusia rosea</i>	Pitch Apple	multi	20	20	overgrown hedge	REMOVE	overgrown hedge
304	<i>Thespesia populnea</i>	Seaside Mahoe	8	25	15	invasive	REMOVE	invasive

NOTE: ALL TREE WORK WILL REQUIRE PERMITTING BY A REGISTERED BROWARD COUNTY TREE TRIMMER.

EXISTING TREE SYMBOLS

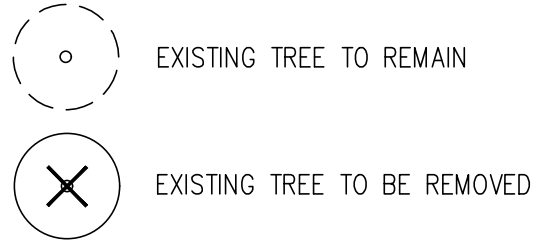

EXISTING TREE KEY

KEY	NAME
AP	Australian Pine
BP	Brazilian Pepper
BS	Gumbo Limbo
CA	Carrotwood
CN	Coconut Palm
CR	Clusia
DL	Areca Palm
FB	Ficus
MI	Mango
MQ	Melaleuca
QV	Live Oak
SM	Mahogany
SP	Sabal Palm
SS	Willow Bustic
TP	Seaside Mahoe

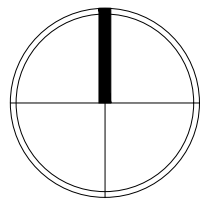

SCALE: 1"=10'-0"

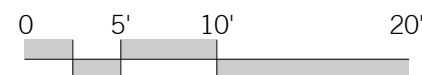

PROJECT

RIVERSIDE TOWNHOMES
117 S RIVERSIDE DRIVE
POMPAÑO BEACH, FL

TITLE

TREE REMOVAL PLAN

PROJ. NO.

FILE NAME

BB DRAWN

03-20-25 DATE

05-12-25 REV.

07-28-25

09-08-25